

Floor Plan

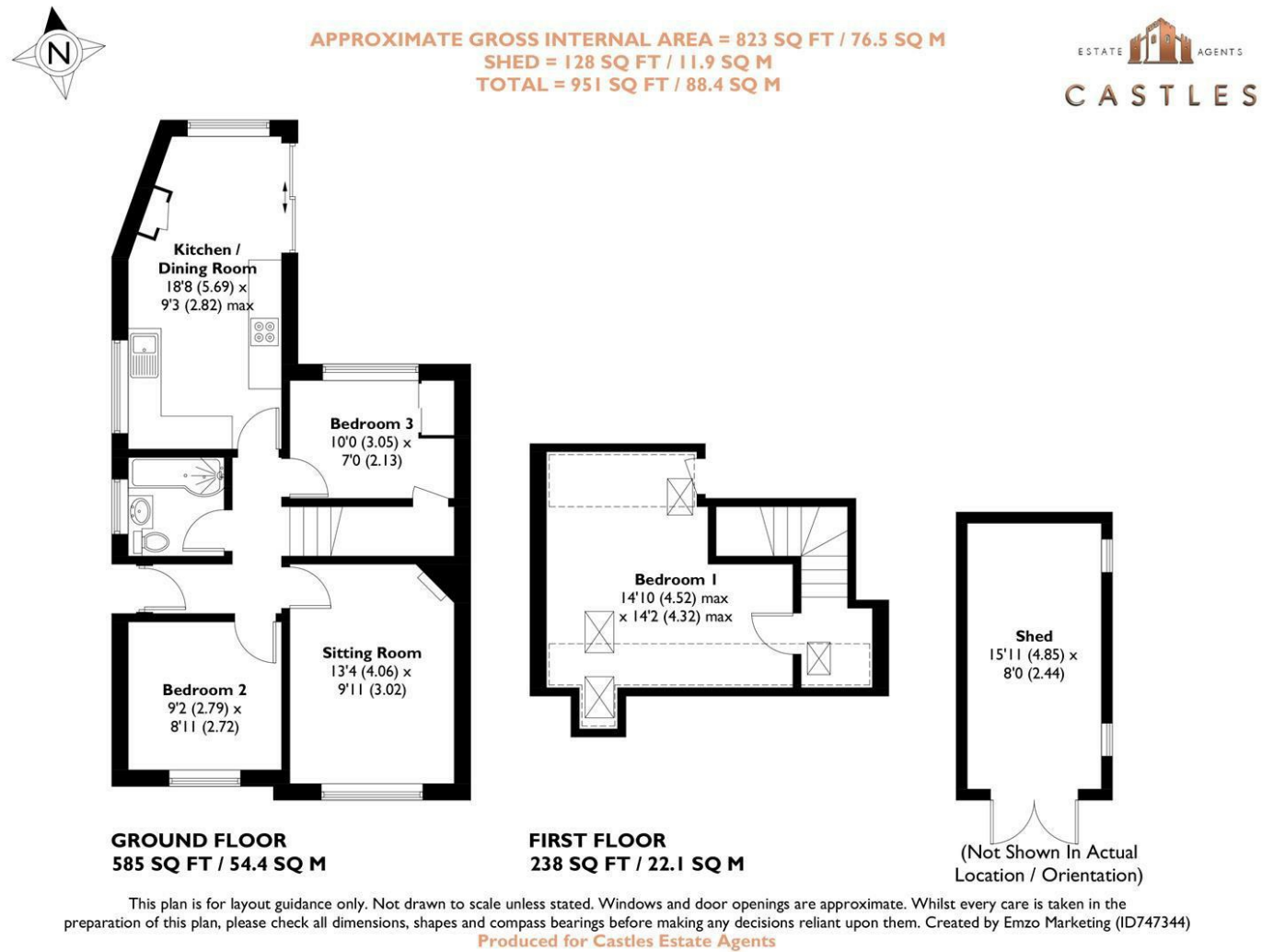

7 Frobisher Grove
Fareham, PO16 9RT

Castles are pleased to welcome to the market this well presented three bedroom semi detached chalet bungalow with off road parking for two cars in the popular location of Frobisher Grove, Portchester.

The ground floor of the property consists of a fair sized lounge area, modern kitchen diner, new bathroom and two double bedrooms. Upstairs a loft conversion has been added to create a large third double bedroom with storage.

Externally the garden is landscaped and features a decked seating area and large shed for storage. There is side access to the garden via a shared driveway. The front of the property is paved allowing two cars to park off road.

Extra benefits to the property are a new fuse board, intruder alarm and CCTV.

For more information on this bungalow or to arrange a viewing please call Castles today.

Offers in excess of £325,000

These particulars, whilst believed to be accurate are set out as a general outline only for guidance and do not constitute any part of an offer or contract. Intending purchasers should not rely on them as statements of representation of fact, but must satisfy themselves by inspection or otherwise as to their accuracy. No person in this firm's employment has the authority to make or give any representation or warranty in respect of the property.

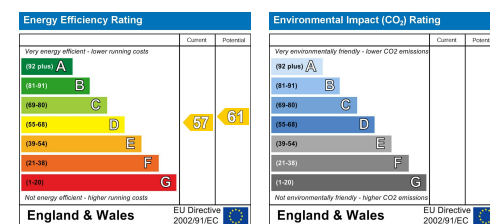

DIRECTORS

CHARLES TUSON • GARY AGAR • SEAN WREN

1 CASTLE STREET
PORTCHESTER
PO16 9QD



02394318899



CHARLES@CASTLESESTATES.CO.UK
GARY@CASTLESESTATES.CO.UK
SEAN@CASTLESESTATES.CO.UK

COMPANY NUMBER: 12821075 • VAT NUMBER: 356389459

7 Frobisher Grove

Fareham, PO16 9RT

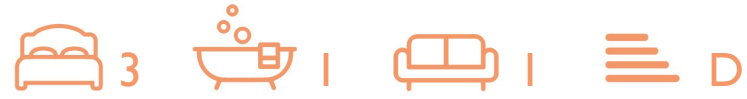

- THREE DOUBLE BEDROOMS
- NEW BATHROOM
- OFF ROAD PARKING
- SEMI DETACHED
- CHALET BUNGALOW
- POPULAR PORTCHESTER LOCATION
- LANDSCAPED GARDEN
- IDEAL FIRST TIME BUY
- CLOSE TO LOCAL SHOPS
- PEACEFUL AREA

LOUNGE

13'3" x 9'10" (4.06 x 3.02)

KITCHEN/DINER

18'8" x 9'3" (5.69 x 2.82)

BATHROOM

BEDROOM ONE

14'9" x 14'2" (4.52 x 4.32)

BEDROOM TWO

9'1" x 8'11" (2.79 x 2.72)

BEDROOM THREE

10'0" x 6'11" (3.05 x 2.13)

Financial Services

If you are looking to get a

comparison on your mortgage deal then do let us know as we can put you in touch with some independent mortgage advisors that would be happy to help. It is always worth a last minute comparison before you purchase a property as the current deals can change weekly.

Solicitors

If you are looking for a solicitor to handle the conveyancing process then do let us know as we can point you in the direction of some local, well recommended companies that would be happy to help and provide you with a quote.

